



MAAG BROTHERS MACHINE WORKS LTD
CH-8700 Küsnacht Switzerland
Phone +41 44 913 66 11, Fax +41 44 913 66 22
info@texmaag.ch, www.texmaag.ch

Inspection, Measuring and Rolling Machine CT6000 Serie



**MAAG Inspection,
Measuring and Rolling Machine
Model CT6000 Serie**

**>>> Especially for
elastic knit fabrics**

Measuring of elastic knit fabrics is very delicate because little tension or even the own weight of the fabric may harm the accuracy of the measurement.

The technology of loose feeding the fabric into the machine, in addition to a release of tension in the fabric by a moving conveyor make it possible to achieve on the MAAG Inspection, Measuring and Rolling Machine CT6000 a very high accuracy of the measurement for all kinds of fabrics up to a high degree of elasticity. This also means no loss of width on most cases.

Working Method >>>

The fabric is fed into the machine from pile, small rolls or from A-frame by a positive drive fitted into a mobile unit. The speed of this unrolling drive is automatically controlled by an very light dancing bar system. A driven feed roller situated immediately after the diameter sensor, creates an overfeed of the fabric before it reaches the slat conveyor.

This slat conveyor has the purpose of relaxing the fabric completely before it is being measured on the succeeding measuring roller. The measurement is taken whilst the fabric is laying on the surface of the measuring roller by an endless belt connected to the actual measuring counter. This system is extremely accurate and approved by the Board of Weights and Measurements in several European countries.

The rolling-up device in front of the machine is side-wards adjustable. A photo-electric selvedge feeler follows the selvedge of the fabric and controls fully automatically, by means of an electro system, the sideways adjustment of the winding device. This will ensure that the fabric is wound accurately selvedge onto selvedge.

The winding tension is adjustable and can be preset to the desired amount to suit individual requirements. The machine is powered by 7 electric motors automatically synchronized in speed. The speed adjustment is infinitely variable from 5–50 m/min. in forward and reverse movement.

Even for high elastic and stretch sensitive fabrics no adjustments are necessary when changing from one quality to another, because the machine will adjust itself automatically.

Machine layout

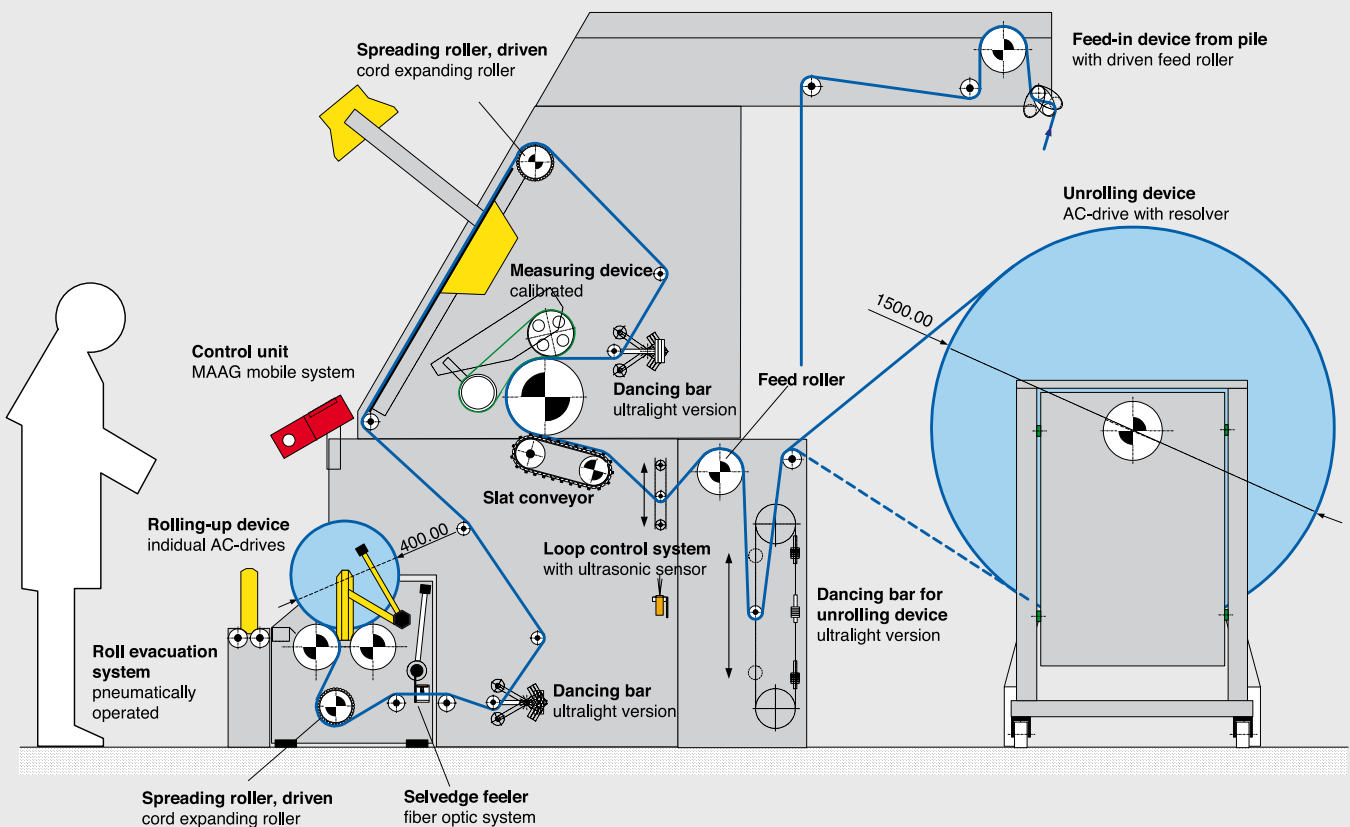

MAAG BROTHERS MACHINE WORKS LTD

CH-8700 Küsnacht Switzerland
Phone +41 44 913 66 11, Fax +41 44 913 66 22
info@texmaag.ch, www.texmaag.ch